

Single roller burnishing tool type ERGK-45

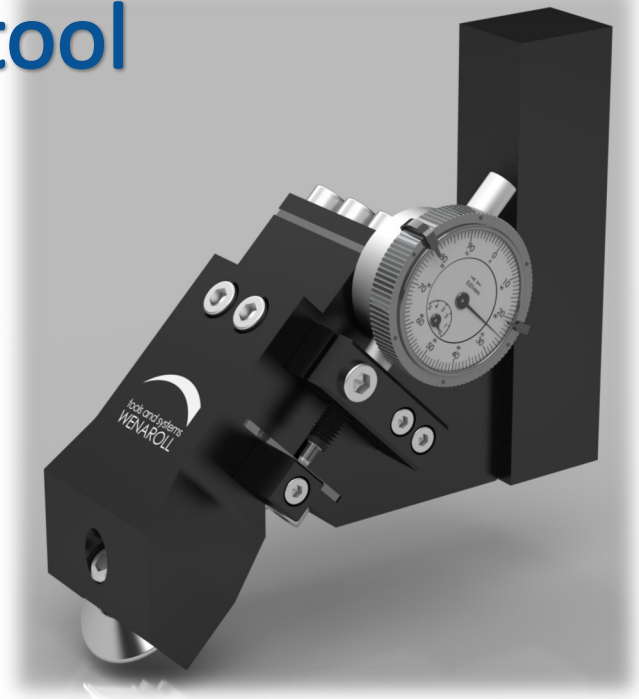

Application :

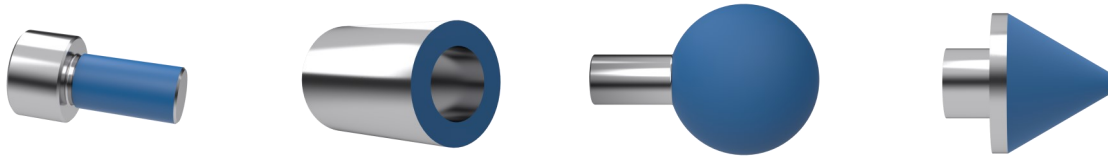

General information:

Tool body	Design	Version	Roller radii	Shank				
				VDI	Cylindrical		Square	
				DIN69880	DIN1835 A	DIN1835 B	SL	SLA
ERGK	45	1	0,8 1,2 1,6 2,5 4,0	VDI 20 (Ø20 x 40)	ZA 20 (Ø20 x 50)	ZS 20 (Ø20 x 50)	SL 16 (16 x 30 x 120)	SLA 16 (16 x 60 x 120)
				VDI 25 (Ø25 x 48)	ZA 25 (Ø25 x 56)	ZS 25 (Ø25 x 56)	SL 20 (20 x 30 x 120)	SLA 20 (20 x 60 x 120)
				VDI 30 (Ø30 x 55)	ZA 32 (Ø32 x 60)	ZS 32 (Ø32 x 60)	SL 25 (25 x 30 x 120)	SLA 25 (25 x 60 x 120)
				VDI 40 (Ø40 x 63)	ZA 40 (Ø40 x 70)	ZS 40 (Ø40 x 70)	SL 32 (32 x 30 x 120)	SLA 32 (32 x 60 x 120)

All dimension in mm

Description:

- 1 Roller unit
- 11 Roller holder
- 16 Tool body
- 17 Dial indicator
- 24 Shank

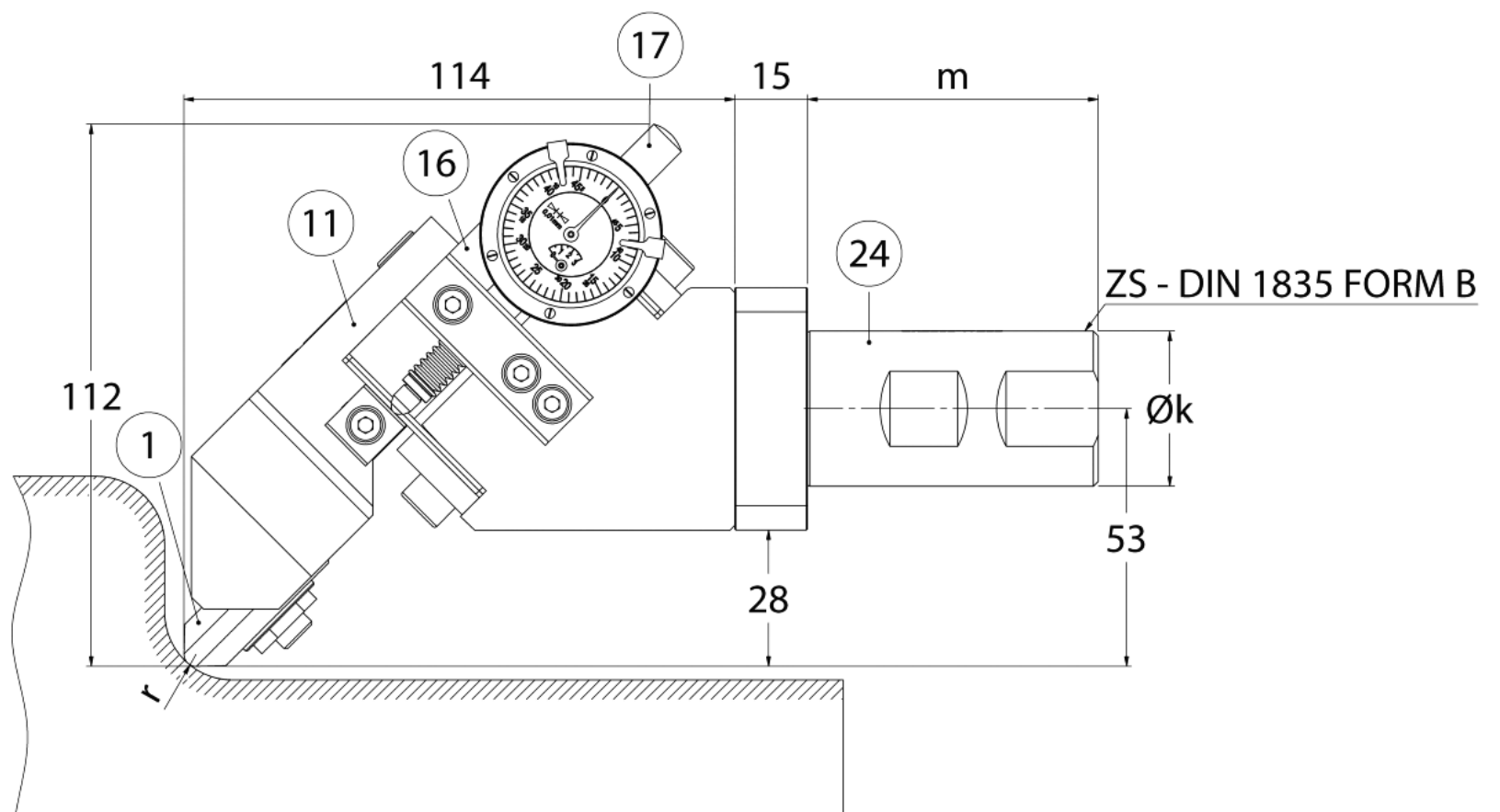

Machining parameter

Tool body	Circumferential speed [m/min]	Feed Rate [mm/revolution]	Rolling Force [N]	Pre-machining-roughness
ERGK 45	max. 300	max. 0,8	4.000	Rz = 5 - 20 µm

Single roller burnishing tool type ERGK-90



Application :

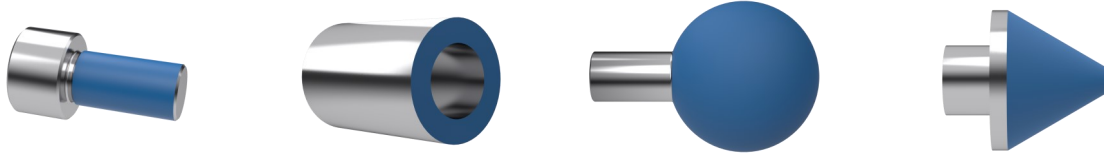

General information:

Tool body	Design	Version	Roller radii	Shank				
				VDI	Cylindrical		Square	
				DIN69880	DIN1835 A	DIN1835 B	SL	SLA
ERGK	90	1	0,8 1,2 1,6 2,5 4,0	VDI 20 (Ø20 x 40)	ZA 20 (Ø20 x 50)	ZS 20 (Ø20 x 50)	SL 16 (16 x 30 x 120)	SLA 16 (16 x 60 x 120)
				VDI 25 (Ø25 x 48)	ZA 25 (Ø25 x 56)	ZS 25 (Ø25 x 56)	SL 20 (20 x 30 x 120)	SLA 20 (20 x 60 x 120)
				VDI 30 (Ø30 x 55)	ZA 32 (Ø32 x 60)	ZS 32 (Ø32 x 60)	SL 25 (25 x 30 x 120)	SLA 25 (25 x 60 x 120)
				VDI 40 (Ø40 x 63)	ZA 40 (Ø40 x 70)	ZS 40 (Ø40 x 70)	SL 32 (32 x 30 x 120)	SLA 32 (32 x 60 x 120)

All dimensions in mm

Descriptions:

- 1 Roller unit
- 11 Roller holder
- 16 Tool body
- 17 Dial indicator
- 24 Shank

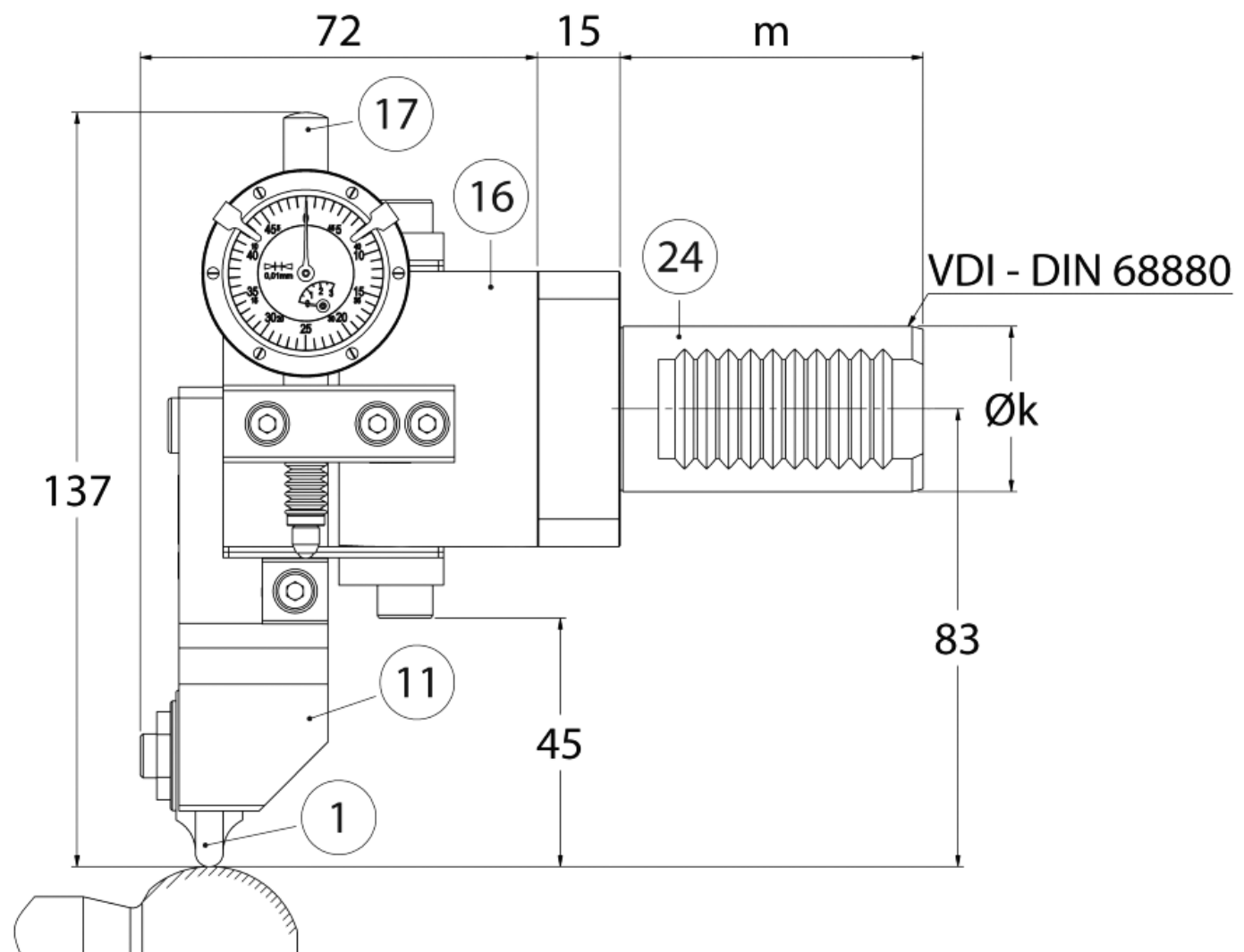

Machining parameters:

Tool body	Circumferential speed [m/min]	Feed rate [mm/revolution]	Rolling force [N]	Pre-machining roughness
ERGK 90	max. 300	max. 0,8	4.000	Rz = 5 - 20 µm